

VISUAL CHECKPOINT

Information use ONLY:

NOT TO BE USED FOR NAVIGATION

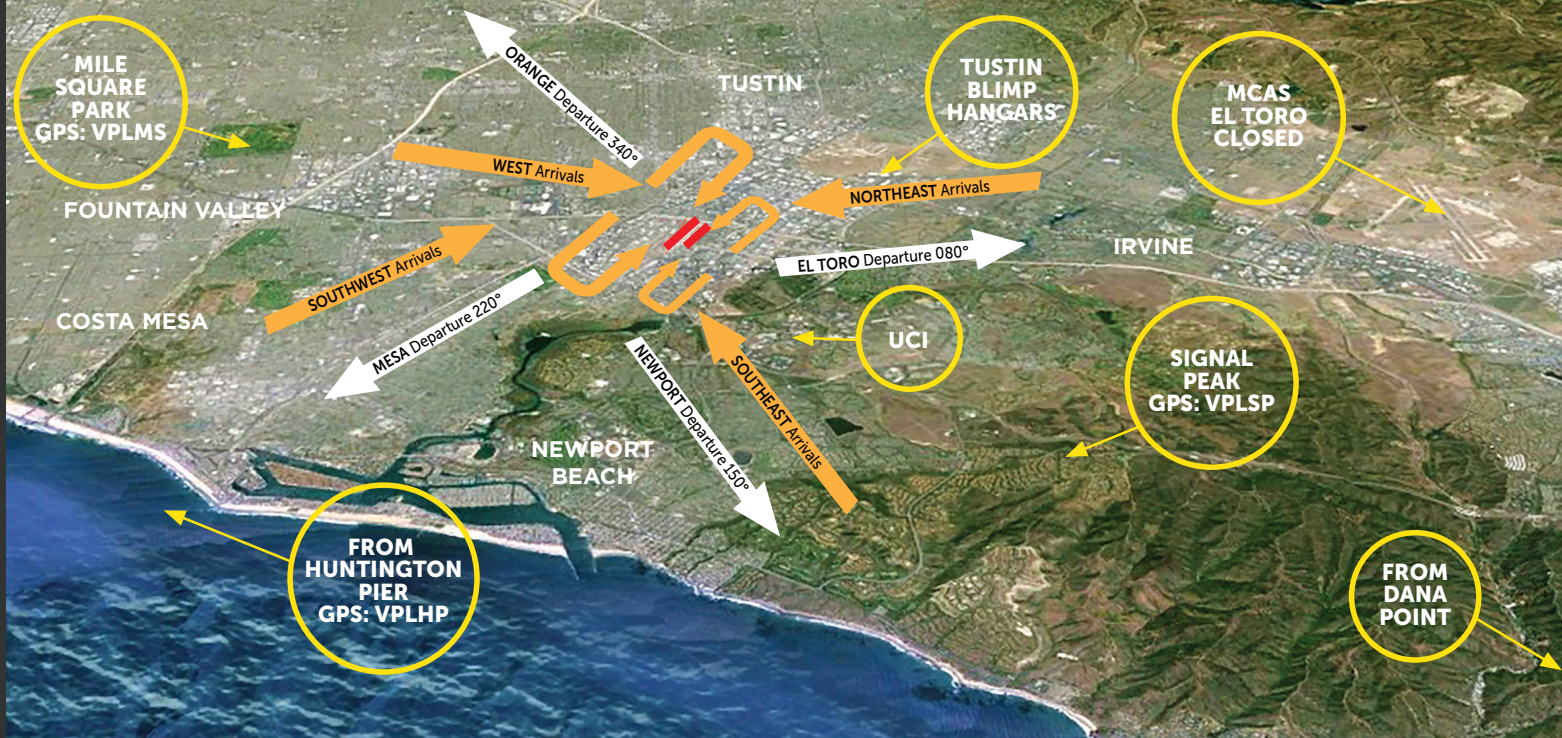

January 2021

JOHN WAYNE AIRPORT (SNA)



PILOT INFORMATION GUIDE

JOHN WAYNE AIRPORT
ORANGE COUNTY

(AVAILABLE AT: WWW.OCAIR.COM)

LOCATION

4 nm S of the City of Santa Ana
N33° 40.54' W117° 52.09'
On Los Angeles Sectional, L3-L4 and Terminal Area Charts

Distances from other airports:

7 nm WSW of MCAS El Toro - CLOSED
16 nm ESE of Long Beach
12 nm SE of Fullerton
19 nm SW of Corona

Distances from NAVAIDS: (• = DME)

NAVAID	Distance (nm)	Heading	DME (nm)	Service
ELB	117.2	255°	7 nm	VOR only
SLI	115.7•	110°	11 nm	VORTAC
PDZ	112.2•	215°	22 nm	VORTAC
OCN	115.3•	303°	34 nm	VORTAC

COMMUNICATIONS FREQUENCIES

Field Elevation: 56 feet MSL

ATIS	(714) 546-2279	126.00
ASOS	(714) 424-0590	
Clearance Delivery		
VFR		121.85
IFR		118.00
John Wayne Ground*	[Unless otherwise assigned by Tower]	
ALL AIRCRAFT		120.80
John Wayne Tower*	[Operates; 0615 - 2300 LCL]	
RWY 20R/2L		126.80
RWY 20L/2R	[RWY 20L/2R CLSD when Tower CLSD]	119.90
Common Traffic Advisory Frequency (CTAF)		126.80
SOCAL Approach Frequencies*		
SW/NW		125.35
E/SE		124.10
NE		121.30
All Jets - Approach		121.30
All Jets - Departure		128.10

*[NOTE: Monitor ATIS prior to contacting Clearance Delivery, Ground, Tower, or Approach Control for frequencies in use.]

NORMAL VFR ARRIVAL ROUTES

Expected Arrival Clearances:

Arriving: **(East)** From El Toro proceed to Signal Peak
Expect: Enter LEFT Traffic, RWY 20L; report UCI.

Arriving: **(SE)** Dana Point and Laguna Beach
Expect: Proceed to Signal Peak for LEFT Traffic, RWY 20L; report UCI.

Arriving: **(SW)** Huntington Pier
Expect: Cross over the control tower at or above 1300 for left downwind entry RWY 20L.

Arriving: **(W/NW)** Mile Square Park
Expect: Cross over the control tower at or above 1300 for left downwind entry RWY 20L.

MISCELLANEOUS APPROACH FREQUENCIES

ILS Localizer/DME:	I-SNA	111.75
LDA Localizer/DME:	I-OJW	108.30
AFSS:	RAL	122.45
VOT:		110.00
ASDE-X in Use:	Pilots should operate transponders with Mode C on all TWYs/RWYs	

TRAFFIC PATTERN ALTITUDES

RWY 2L - 20R TPA:

1056 (1000) small aircraft, 1556 (1500) turbine aircraft over 12500 lbs.

RWY 2R - 20L TPA:

856 (800) small single engine aircraft, 1056 (1000) twin engine aircraft.

NORMAL VFR DEPARTURE ROUTES

Departing E/NE: El Toro Departure – " Heading 080° "

Departing SE: Newport Departure – " Heading 150° "

Departing SW: Mesa Departure – " Heading 220° "

Departing NW: Orange Departure – " Heading 340° "

Squawk Code, Advisory Frequency and Altitude as assigned.

Pilots not requesting radar service beyond the surface area of the Class C airspace may state "local" when requesting their departure route. (Example: "John Wayne Clearance, Cessna N739MB, west-side parking, Mesa Local Departure.") Local radar service will be terminated upon exiting the 5 nm surface area of the Class C airspace. Pilots must then remain clear of all other regulated airspace, including the upper tier of the Class C airspace.

AVOID OVERFLIGHT OF RWY 20R/2L

VFR aircraft - to avoid overflight of RWY 20R/2L:

RWY 20L arrival fly final at 15° angle to RWY.

RWY 20L departures turn LEFT 15° at departure end of runway.

To avoid overflights of RWY 2L, RWY 2R departures turn

RIGHT 15° at departure end of runway.

JAY'S MAINTENANCE

2980 Airway Avenue
Costa Mesa, CA 92626
(714) 433-2275

MARTIN AVIATION

19300 Ike Jones Road
Santa Ana, CA 92707
(714) 210-2945

CLAY LACY AVIATION

Frequency: 131.375
361 Paularino Avenue
Costa Mesa, CA 92626
(714) 888-8000

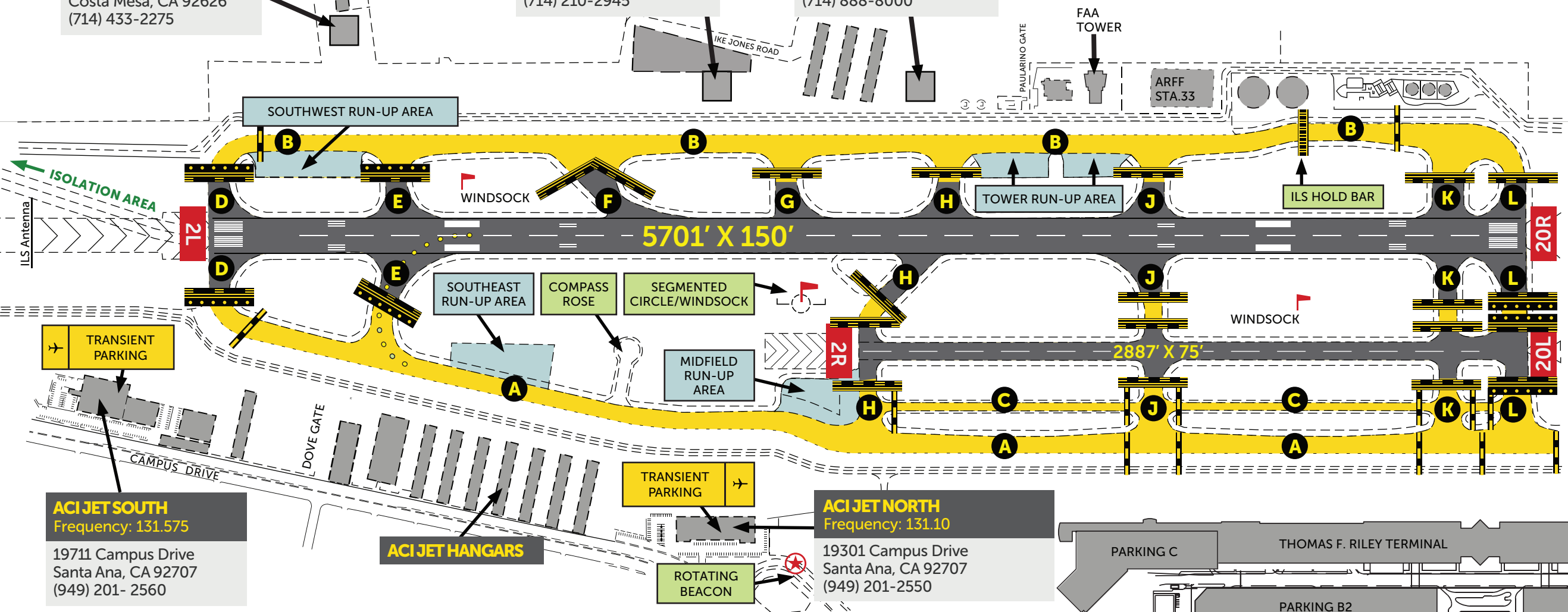

ACIJET SOUTH

Frequency: 131.575







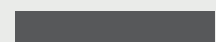
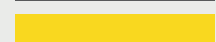

19711 Campus Drive
Santa Ana, CA 92707
(949) 201-2560

ACIJET NORTH

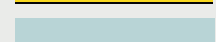
Frequency: 131.10

19301 Campus Drive
Santa Ana, CA 92707
(949) 201-2550

LEGEND

-  Runway Environment
-  Taxiway Environment
-  Runway Holding Position Markings
-  Run-up Areas
-  In-Pavement Guard Lights
-  Taxiway Lead-off Lights
-  Surface painted hold and enhanced centerline markings at RWY/TWY
-  Runway Hold Position Signs
-  Elevated Guard Lights at all intersections
-  Taxiway Hold Short Position

HELP PREVENT RUNWAY INCURSIONS

1. **"READ BACK"** ALL RUNWAY HOLD SHORT INSTRUCTIONS.
2. BE VIGILANT WHEN OPERATING IN VICINITY OF TWY H, TWY C, RWY20L INTERSECTION.
3. WHEN IN DOUBT TELL CONTROLLERS **"UNFAMILIAR"** AND REQUEST PROGRESSIVE TAXI INSTRUCTIONS.
4. BE FAMILIAR - KNOW LAYOUT, SIGNAGE AND MARKINGS.
5. **YOUR ACTIONS CAN MAKE ALL THE DIFFERENCE!**